

PARAMOUNT
palmera
INDUSTRIAL PARK @ BUKIT MINYAK

CURATE
YOUR
BUSINESS
SPACE

PARAMOUNT
PROPERTY

The People's Developer™

MADE FOR MODERN-STYLE COMMERCE



Gone are the days when business operations are confined by the space that you're in. In today's business and commerce, it's all about flexibility and versatility. With Paramount Palmera, you'll own a space that is ready to adapt and evolve with the growth of your business.

PARAMOUNT
palmera

INDUSTRIAL PARK @ BUKIT MINYAK
ALL ABOUT
FLEXIBILITY
AND
VERSATILITY

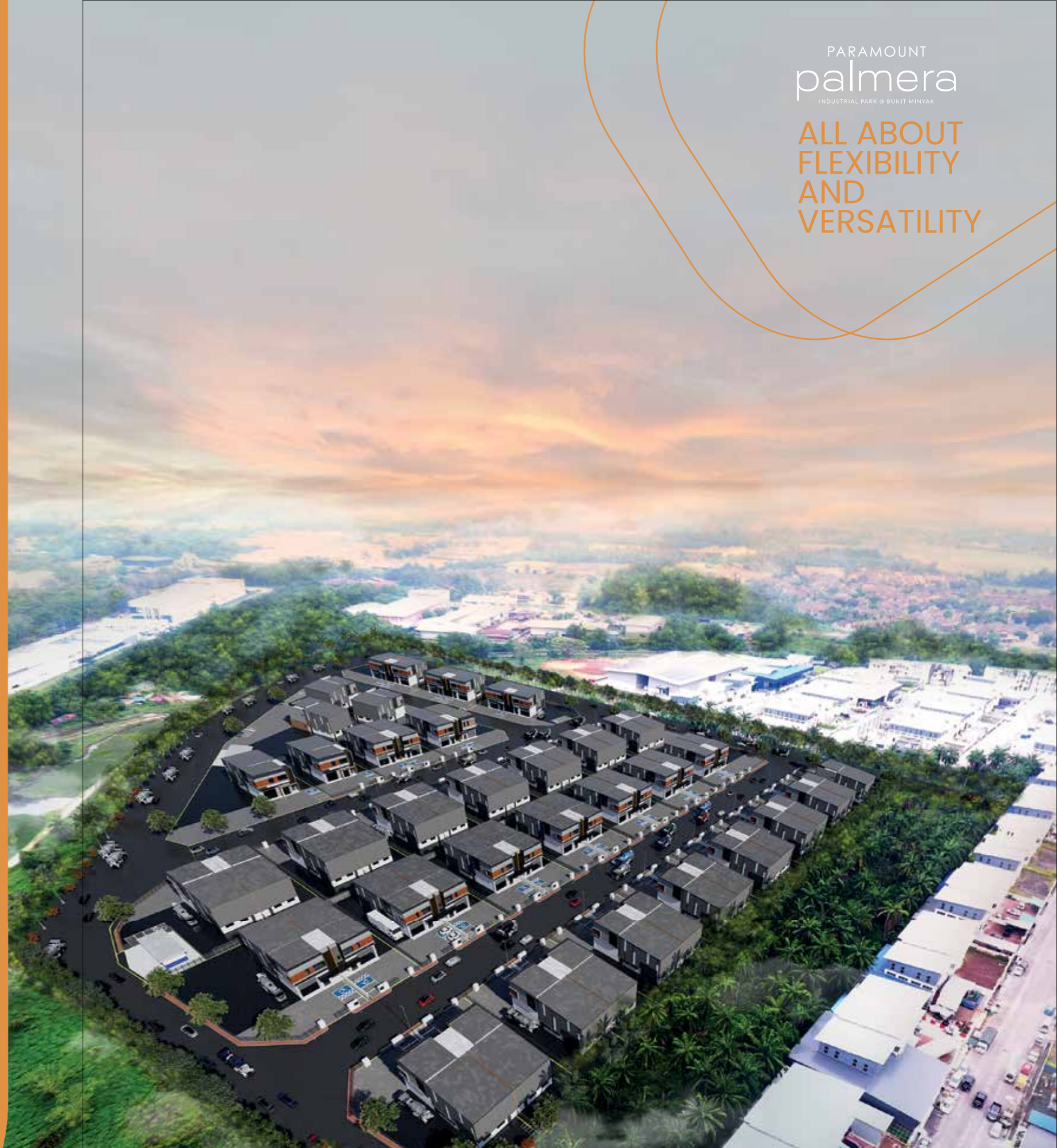

MORE WINNING FACTORS FOR YOUR BUSINESS

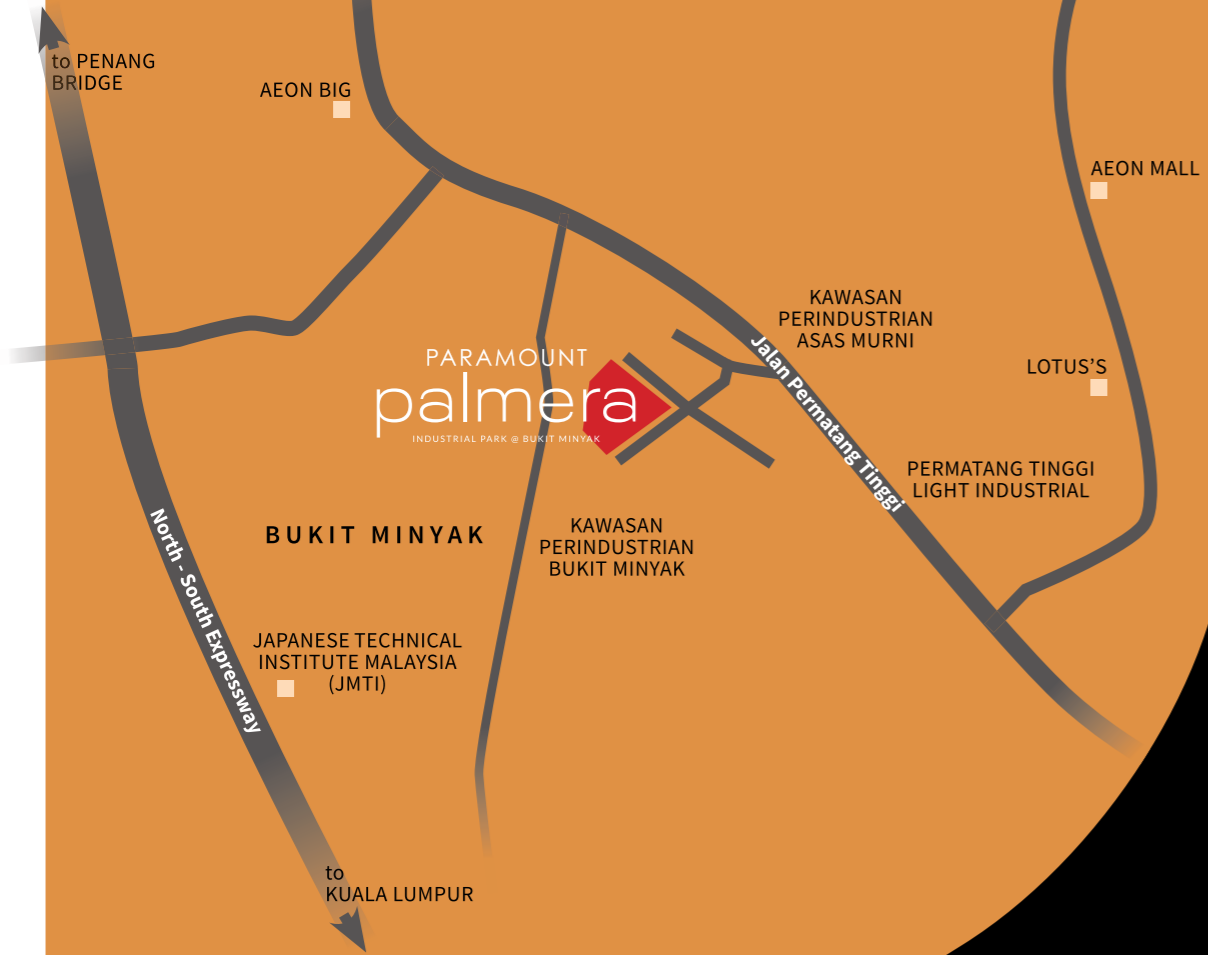

PARAMOUNT
palmera
INDUSTRIAL PARK @ BUKIT MINYAK

EASY ACCESS AND CENTRALLY CONNECTED



- 52 units** Semi-Detached Light Industrial Units
- 6 units** Fully-Detached Light Industrial Units
- 3 units** TNB



Location and connectivity matter in business regardless of the nature of your operations. Paramount Palmera is located at Bukit Minyak, an area known for its industrial activities with well-established transportation channels within easy access and centrally connected to major highways.

ADAPTIVE TO THE WAY YOU WANT IT

9m clear height that maximises space utilisation

Front loading with roller shutters up to **4.8m** height

Designated space for **signboard visibility**

Expandable warehousing space to include a mezzanine

Floor loading up to **1 ton/m²**

Extra wide sliding gate for easy access



SEMI-DETACHED

Light Industrial Units

Lot Size: 130' x 60' Built-up Area: 3,929 sq ft

PARAMOUNT
palmera
INDUSTRIAL PARK @ BUKIT MINYAK
PERSPECTIVE



SEMI-DETACHED Light Industrial Units

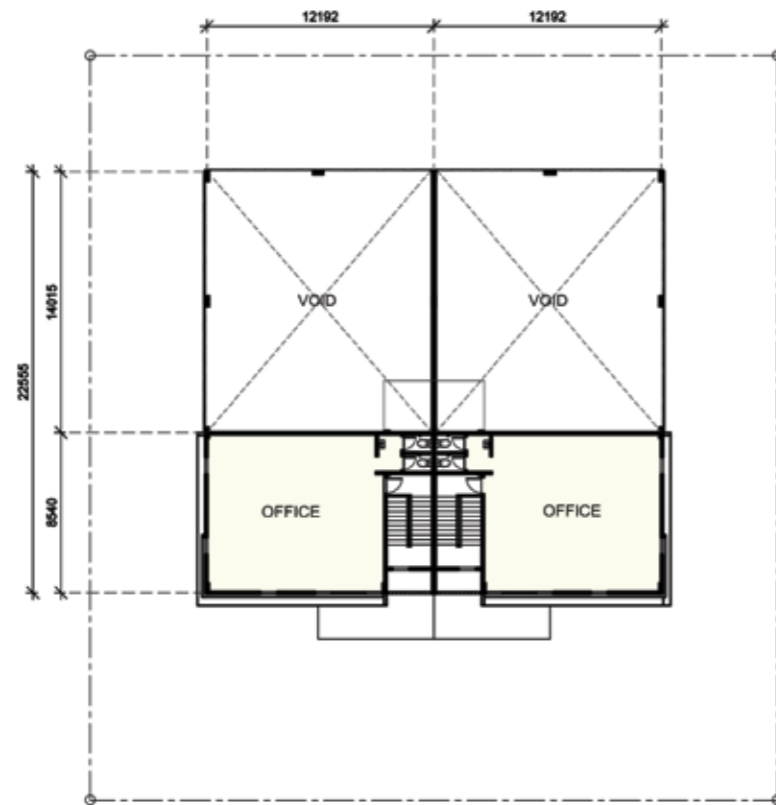

FIRST FLOOR

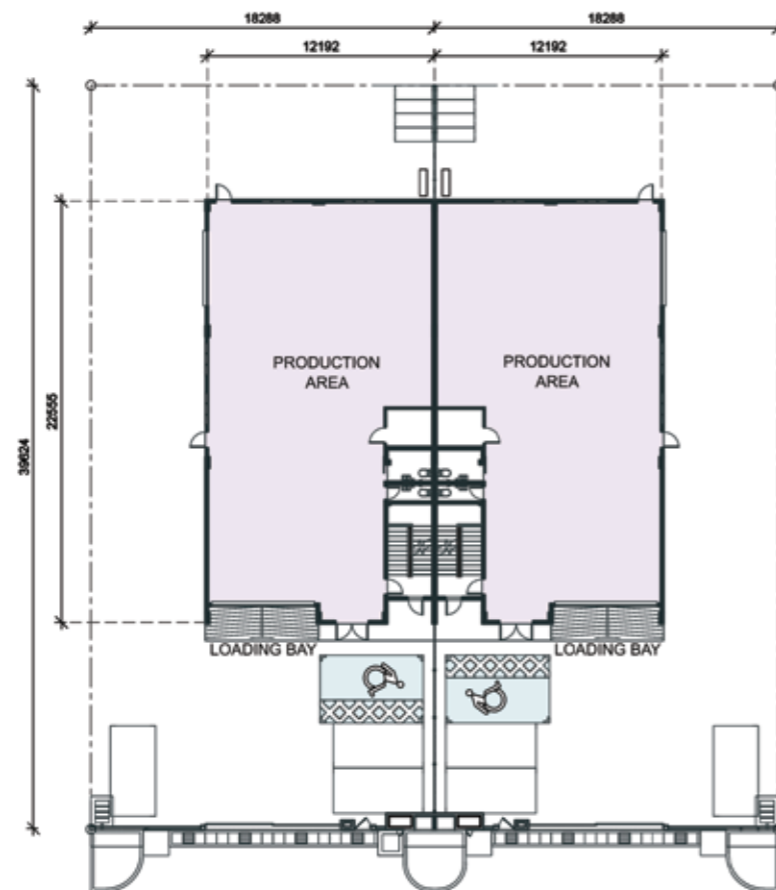

GROUND FLOOR

STRUCTURE

Reinforced concrete / Steel frame

WALL

Brick wall / Metal cladding wall /
Blockwall

ROOF COVERING

Metal deck roof

CEILING

Suspended ceiling / Skim coat

WINDOWS

Aluminum framed glass window

DOORS

Aluminum framed glass door / Steel flush door /
Timber flush door / Fire rated door

IRONMONGERY

Locksets and accessories

WALL FINISHES

Cement render and paint / Tiles /
Metal cladding / Dry wall partition

FLOOR FINISHES

Tile / Cement render / Power float floor

SANITARY FITTINGS

DESCRIPTION	SEMI-DETACHED UNIT
Water Closet	4
Basin with tap	3
Tap Point	1

ELECTRICAL INSTALLATION

DESCRIPTION	SEMI-DETACHED UNIT
Lighting Point	20
13A Power Point	22
20A Power Point	3
Wall Fan Point	1
Auto gate socket outlet point	1

NOTE : All drawings are subject to change as directed by the relevant authorities and developer's architect.
Where there is DISCREPANCY between metric and imperial measurement, the metric measurement should prevail over the imperial measurement.

FULLY-DETACHED

Light Industrial Units

Lot Size: 130' x 90' Built-up Area: 4,935 sq ft

PARAMOUNT
palmera
INDUSTRIAL PARK @ BUKIT MINYAK
PERSPECTIVE



FULLY-DETACHED Light Industrial Units

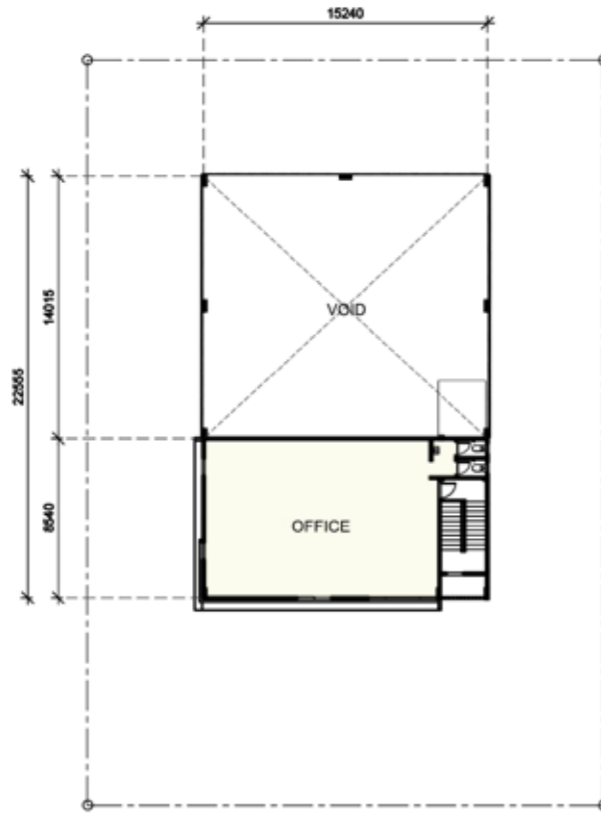

FIRST FLOOR



GROUND FLOOR

STRUCTURE

Reinforced concrete / Steel frame

WALL

Brick wall / Metal cladding wall / Blockwall

ROOF COVERING

Metal deck roof

CEILING

Suspended ceiling / Skim coat

WINDOWS

Aluminum framed glass window

SANITARY FITTINGS

DESCRIPTION	DETACHED UNIT
Water Closet	4
Basin with tap	3
Tap Point	1

ELECTRICAL INSTALLATION

DESCRIPTION	DETACHED UNIT
Lighting Point	23
13A Power Point	22
20A Power Point	3
Wall Fan Point	1
Auto gate socket outlet point	1

DOORS

Aluminum framed glass door / Steel flush door / Timber flush door / Fire rated door

IRONMONGERY

Locksets and accessories

WALL FINISHES

Cement render and paint / Tiles / Metal cladding / Dry wall partition

FLOOR FINISHES

Tile / Cement render / Power float floor

NOTE : All drawings are subject to change as directed by the relevant authorities and developer's architect. Where there is DISCREPANCY between metric and imperial measurement, the metric measurement should prevail over the imperial measurement.



The People's Developer

Paramount Property strives to be the people's developer, creating spaces that will truly make lives better for all.

We strive to Design for Life, creating products to suit the different stages of life's journey. We place People First, from the people we build for, to those who grow with us – we make their needs our priority. We work to Uplift Communities through sustainability practices and by supporting initiatives that will leave the world a better place for many more years to come.



Scan for
more info!

 ParamountPropertyMalaysia  paramountpropertymy  Paramount Property Malaysia

 Paramount Property Gallery @ Utropolis Batu Kawan
Paramount Holdings Sdn Bhd 200201016876 (584539-D)
G-01, Utropolis Utama, Persiaran Cassia Barat 3,
14110 Bandar Cassia, Pulau Pinang, Malaysia.

012 501 0733
paramountproperty.my

PARAMOUNT
PROPERTY
The People's Developer™